

5.00
4.20
Ø 1.94
.50 X .25
KEYWAY

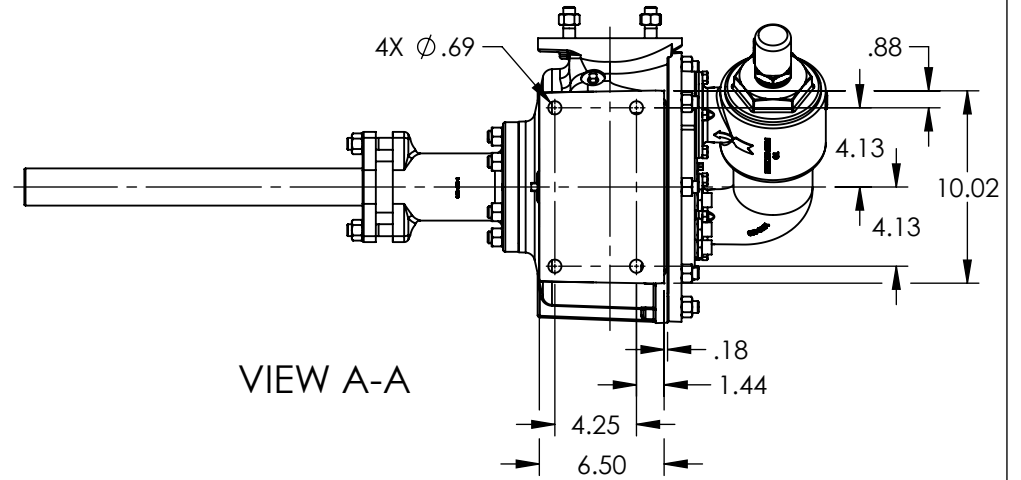

VIEW A-A

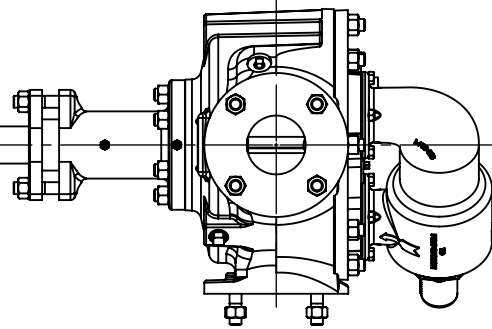
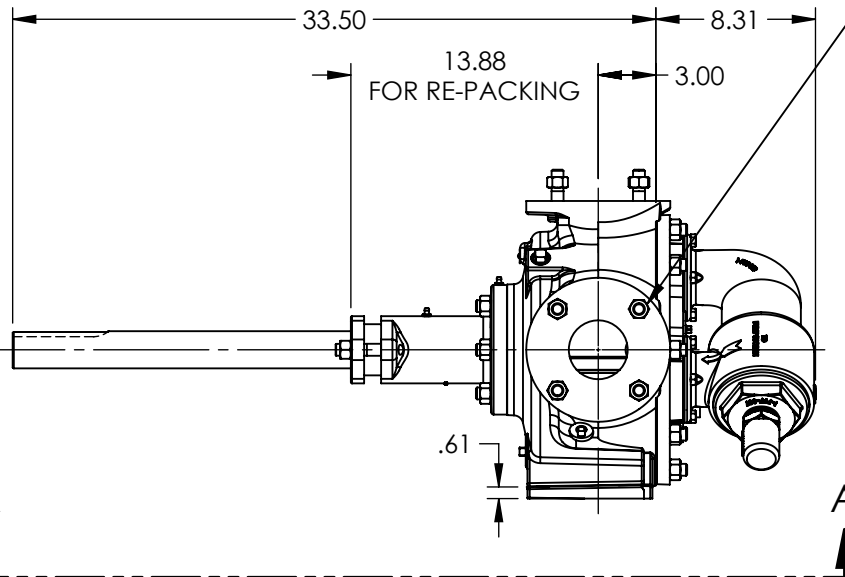

PORTS: 2X-3" FLANGES
SUITABLE FOR USE WITH
CLASS 125 ANSI FLANGES

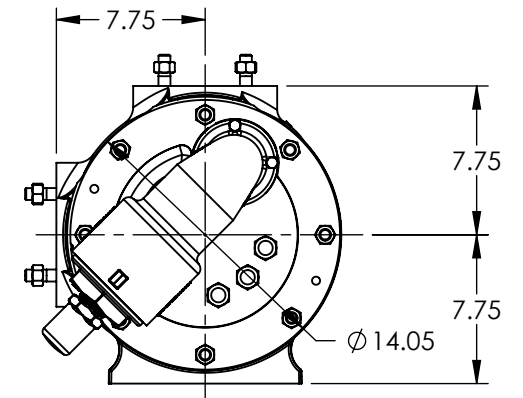

NOTES:
1. ALL DIMENSIONS ARE FOR REFERENCE ONLY.
2. HEATER CONDUIT HIDDEN FOR CLARITY.

STANDARD MODEL: Q32E

STATE	Released	08/09/2018
DRAWN	sbaldwin	01/15/2015
CHECKED	BAM	08/09/2018

DIMENSIONS ARE IN INCHES	
PROJECT: E121	
WAS: EX-E121-3	

**VIKING
PUMP**

VIKING PUMP, INC.
A Unit of IDEX Corporation
Cedar Falls, IA 50613
U.S.A.

THIS DRAWING IS THE PROPERTY OF
VIKING PUMP, INC. AND IS PROPRIETARY
IN GENERAL AND DETAIL. IT SHALL NOT BE
COPIED OR ITS CONTENTS REVEALED TO
OUTSIDE PARTIES WITHOUT THE WRITTEN
CONSENT OF VIKING PUMP, INC.

3D

DWG. NO.
QV-2061

SHEET 1 OF 1

REV. A.1

08/09/2018