

VIEW A-A

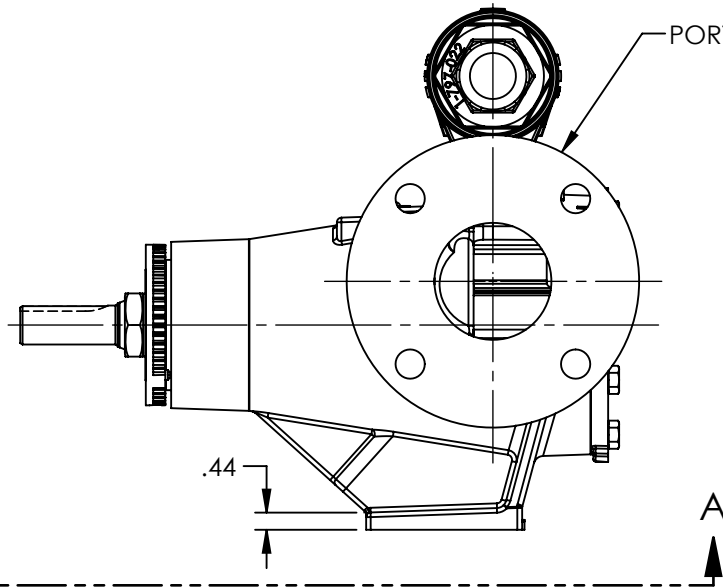

PORTS: 2X 3" FLANGES  
SUITABLE FOR USE WITH  
CLASS 150 ANSI FLANGES

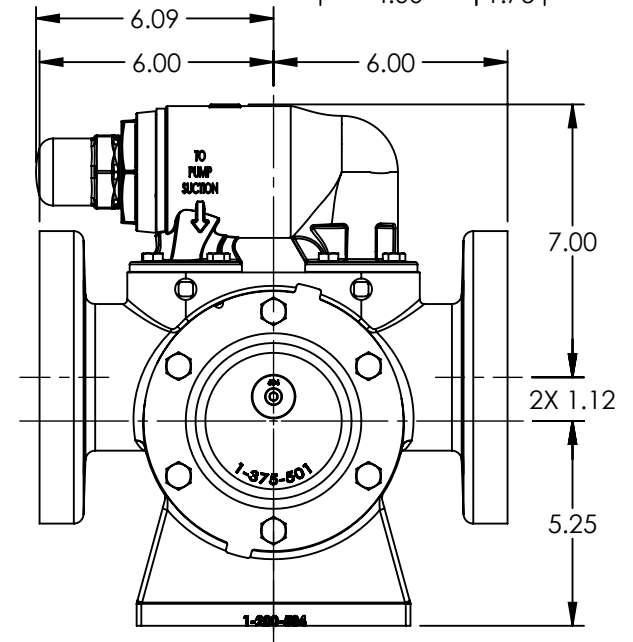

STANDARD MODEL: AL4197

NOTES:  
1. ALL DIMENSIONS ARE FOR REFERENCE ONLY.

STATE	Released	01/09/2019
DRAWN	sjakel	01/08/2019
CHECKED	BAM	01/08/2019

DIMENSIONS ARE IN INCHES	
PROJECT:	
WAS:	



VIKING PUMP, INC.  
A Unit of IDEX Corporation  
Cedar Falls, IA 50613  
U.S.A.

THIS DRAWING IS THE PROPERTY OF VIKING PUMP, INC. AND IS PROPRIETARY IN GENERAL AND DETAIL. IT SHALL NOT BE COPIED OR ITS CONTENTS REVEALED TO OUTSIDE PARTIES WITHOUT THE WRITTEN CONSENT OF VIKING PUMP, INC.

3D

DWG. NO.  
AV-813

SHEET 1 OF 1

REV. C.0

01/09/2019