

VIEW A-A

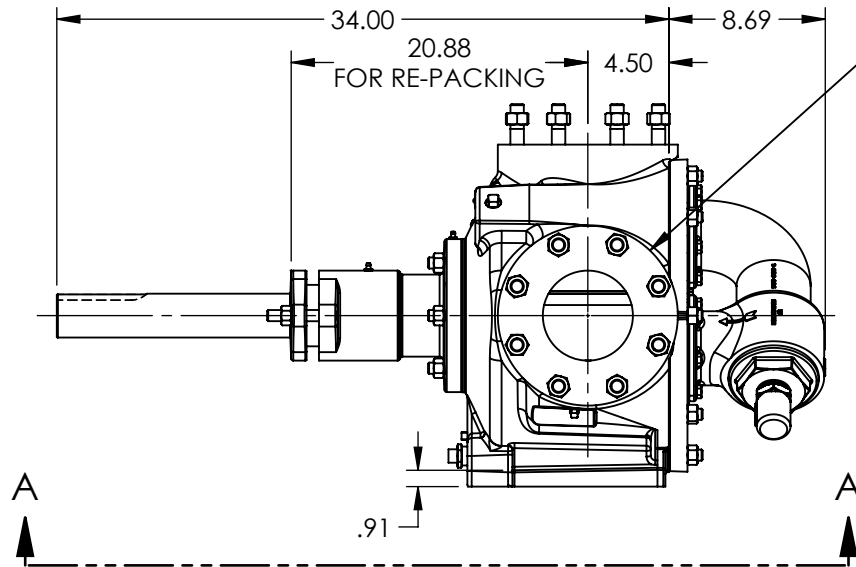

PORTS: 2X 5" FLANGES  
SUITABLE FOR USE WITH  
CLASS 125 ANSI FLANGES

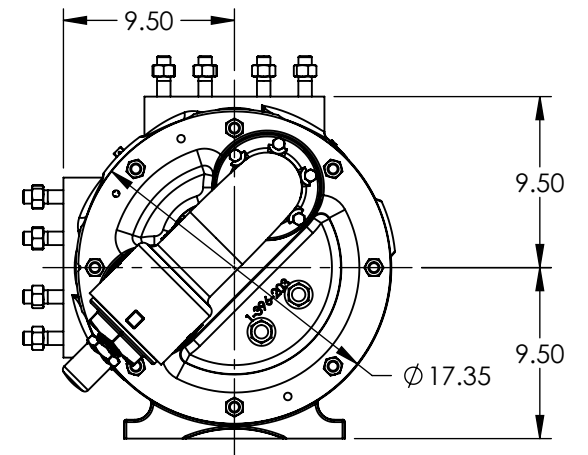

- NOTES:  
1. ALL DIMENSIONS ARE FOR REFERENCE ONLY.  
2. HEATER CONDUIT HIDDEN FOR CLARITY.

STANDARD MODEL: N32E

STATE	Released	08/09/2018
DRAWN	sbaldwin	01/15/2015
CHECKED	SJJ	08/09/2018

DIMENSIONS ARE IN INCHES	
PROJECT:	
WAS:	



VIKING PUMP, INC.  
A Unit of IDEX Corporation  
Cedar Falls, IA 50613  
U.S.A.

THIS DRAWING IS THE PROPERTY OF VIKING PUMP, INC. AND IS PROPRIETARY IN GENERAL AND DETAIL. IT SHALL NOT BE COPIED OR ITS CONTENTS REVEALED TO OUTSIDE PARTIES WITHOUT THE WRITTEN CONSENT OF VIKING PUMP, INC.

3D

DWG. NO.  
NV-745

SHEET 1 OF 1

REV. B.0  
08/09/2018